

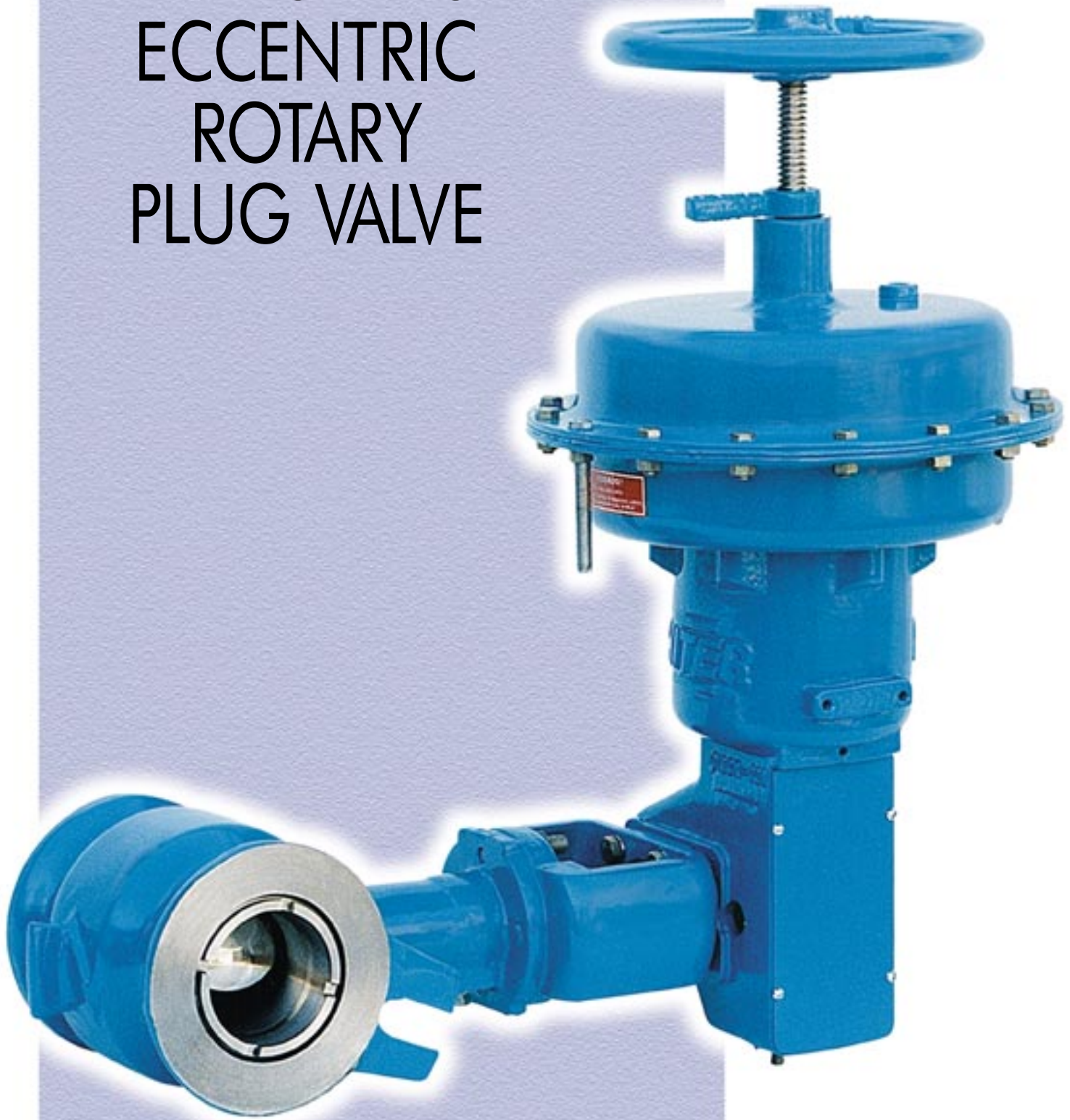

# RPH SERIES ECCENTRIC ROTARY PLUG VALVE



## Features

### Characteristic

Control valve with eccentric rotating plug and self-aligning characteristic at the contact with the seat which provide an excellent shutoff with a low torque.

### Available Types

**RPH-02** – With metal seat.

**RPH-11** – With PTFE seat.

### Sizes

From 1 to 12 in.

### Pressure-Temperature Ratings

ANSI B16.34 Classes 150 to 600.

### Body Construction

Body with extended integral bonnet. Flangeless for wafer assembly or flanged construction.

### Face-to-Face Dimension

According to ANSI/ISA-S75.04.

### Materials

Body in carbon steel, stainless steel or special alloys. Hard faced stainless steel or special alloys trim.

### Flow Characteristic

Linear.

### Flow Coefficient - Cv

See table 1 for full area. Also available with reduced capacity, upon request.

### Temperature Limits

-95 °C (-320 °F) to +400 °C (+750 °F).

### Shutoff Classifications

**RPH-02**– Class IV according to ANSI/FCI 70-2.

**RTC-11** – Class VI according to ANSI/FCI 70-2.

### Optional Constructions

Trim for slurry service. Packing follower with O'ring seal for fugitive emission control.

## Main parts identification

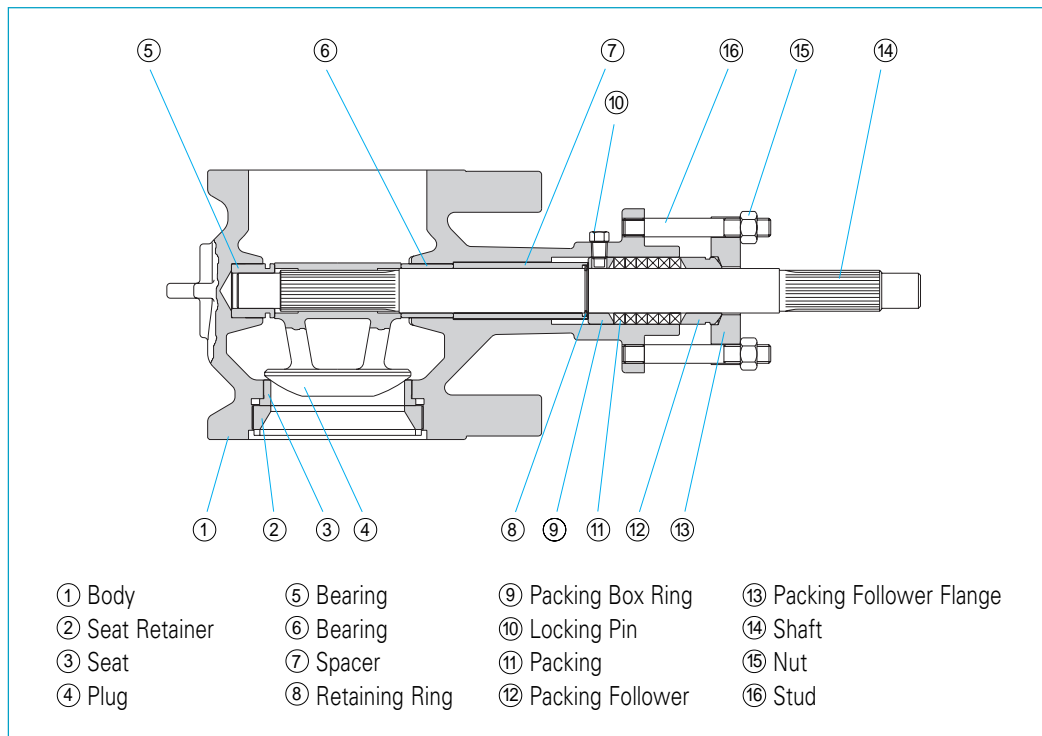
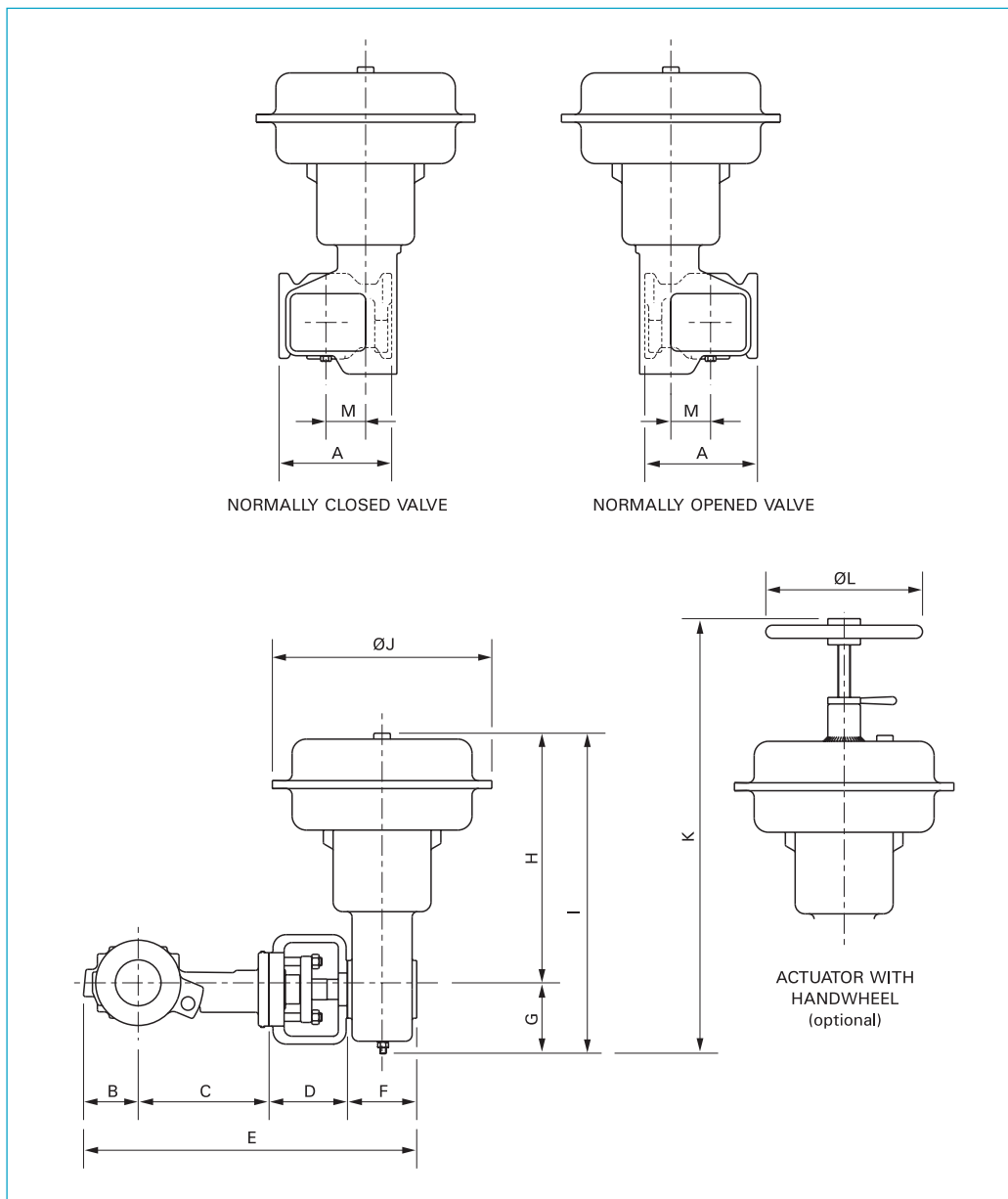

Table 1  
Flow coefficient - Cv

BODY SIZE (in.)	OPENING ANGLE				
	10°	20°	30°	40°	50°
1	2.1	5.9	9.6	12.2	14.2
1.5	4.5	12.1	20.2	26.2	30.3
2	7.6	21.2	34.3	44.4	50.5
3	18.2	45.4	78.5	114	136
4	30.2	76.5	134	193	232
6	65.4	166	292	421	504
8	112	321	546	727	855
10	170	490	835	1116	1306
12	230	659	1123	1498	1758

Dimensions  
(valve with  
diaphragm/spring  
pneumatic actuator)



BODY SIZE (in.)	DIMENSIONS (mm)												
	A	B	C	D	E	F	G	H	I	ØJ	K	ØL	M
1	102	38	116	72.5	226.5	86	82	294	376	285	560	235	43
1.5	114	51	144	72.5	267.5	86	83	293	376	285	560	235	43
2	124	66	149	72.5	287.5	86	85	291	376	285	560	235	43
3	165	84	200	120	404	110	110	380	490	336	691	235	61
4	194	109	223	120	452	110	110	380	490	336	691	235	61
6	229	146	262	158	690	124	129	449	578	410	793	340	86
8	243	202	300	158	784	124	132	446	578	410	793	340	86
10	297	250	372	186	956	148	159	544	703	476	953	480	100
12	338	275	407	186	1016	148	162	541	703	476	953	480	100

Normally operated by pneumatic diaphragm/spring actuator or piston actuators, spring return or double action.

Can also be supplied with gearbox for manual operation or electric actuator.

Actuators

## Ordering information

1. Valve size and type
2. End connection style
3. Body material
4. Trim material
5. Maximum working condition
6. Normal working condition
7. Minimum working condition
8. Shutoff differential pressure
9. Specific gravity
10. Specific heat ratio
11. Critical pressure
12. Critical temperature
13. Viscosity
14. Inlet and outlet pipe diameter and thickness



*HITER IND. E COM. CONTR. TERMO-HIDR. LTDA.  
Rua Capitão Francisco Teixeira Nogueira, 233  
CEP 05037-030 - Água Branca - São Paulo - Brasil  
Phone.: +55 11 3611.0788  
Fax: +55 11 3611.0921/3611.1711  
e-mail: vendas@hiter.com.br - www.hiter.com.br*

Representative

Bulletin 1184 / July 2000