

FE SERIES



QUICK CLOSING VALVE



Main Parts Identification

- ① Tripping Device
- ② Handle
- ③ Body
- ④ Cover
- ⑤ Arm
- ⑥ Disc
- ⑦ Seat

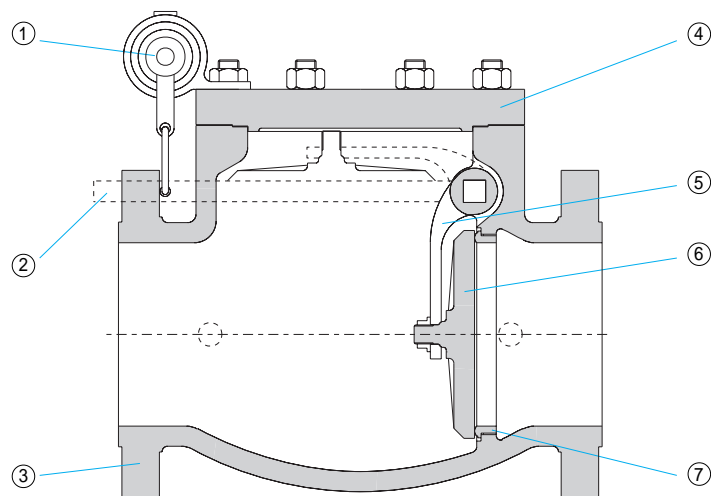

Features

Characteristic

Provides emergency shut-off on tanks and lines to stop the flow immediately in the event of pressure loss, fire or other emergency. A variety of tripping mechanisms can be used individually or combined to release the spring loaded handle and close the valve.

Tripping Mechanisms

Fusible Link

Melts in case of fire in the vicinity of the valve. Standard melting temperature is 100°C, other temperatures are available on application.

Pneumatic Actuator

Releases the valve arm with either the application of pneumatic pressure or the failure of pneumatic pressure. On gas applications can be operated by the process fluid.

Solenoid Actuator

Releases the valve arm with either the application of electric power or the failure of electric power.

Block and Bleed Pilot

Operates a pneumatic safety system preventing high pressure damage (high trip) and/or sense a line break (low trip). Set pressures from 5 up to 10,000 psig.

Manual Operator

To release the valve arm locally or with optional remote cable.

Sizes

2, 3, 4, 6, 8, 10, 12, 14, 16, 18, 20, 22 and 24 in. Other sizes may be supplied upon request.

End Connections

FR - Raised Face - sizes 2 to 24 in.

RTJ - Ring Joint - sizes 2 to 24 in.

S W - Socket Welding - 2 in. size.

BW - Butt Welding - sizes 3 to 16 in.

Pressure-Temperature Rating

ANSI B16.34 classes 150, 300, 600, 900 or 1500.

Body Material

ASTM A 216 Gr. WCB carbon steel, ASTM A 352 Gr. LCB carbon steel, ASTM A 351 Gr. CF8 stainless steel or ASTM A 351 Gr. CF8M stainless steel. Other materials are available on application.

Trim Material

304 or 316 stainless steel. Other materials are available on application. PTFE seat is available.

Shutoff Classification

ANSI/FCI 70-2 Class V for metal seat or Class VI for soft seat.

Face-to-face
dimension

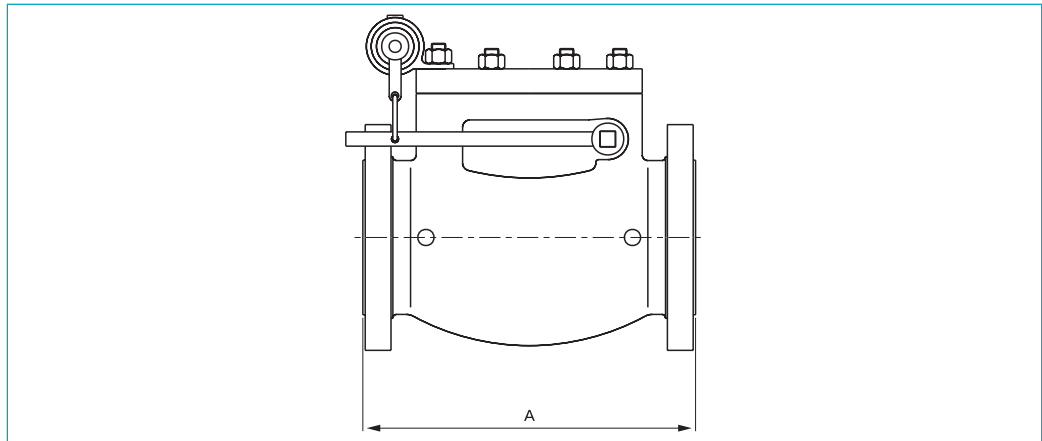

ANSI CLASS	A ⁽¹⁾ (mm)												
	VALVE SIZE (in.)												
	2	3	4	6	8	10	12	14	16	18	20	22	24
150	241.3	317.5	381.0	445.0	508.0	622.3	660.4	793.7	863.6	977.9	977.9	1066.8	1295.4
300	241.3	317.5	381.0	445.0	508.0	622.3	660.4	793.7	863.6	977.9	1016.0	1117.6	1346.2
600	241.3	317.5	381.0	561.9	660.4	787.4	838.2	889.0	990.6	1092.2	1193.8	1295.4	1397.0
900	368.3	381.0	457.2	609.6	736.6	838.2	965.2	1028.7	1130.3	1219.2	1320.8	-	1549.4
1500	368.3	469.9	546.1	704.8	831.8	990.6	1130.3	1257.3	1384.3	1536.7	1663.7	-	1943.1

(1) For raised face flanges.

Accessories

Limit switches.

HITER

HITER IND. E COM. CONTR. TERMO-HIDR. LTDA.
Rua Capitão Francisco Teixeira Nogueira, 233
CEP 05037-030 - Água Branca - São Paulo - Brasil
Phone.: +55 11 3611.0788
Fax: +55 11 3611.0921/3611.1711
e-mail: vendas@hiter.com.br - www.hiter.com.br

Representative

Bulletin 1179 / Rev. July 2000